

NOTES:
DO NOT SCALE. IF IN DOUBT, ASK.

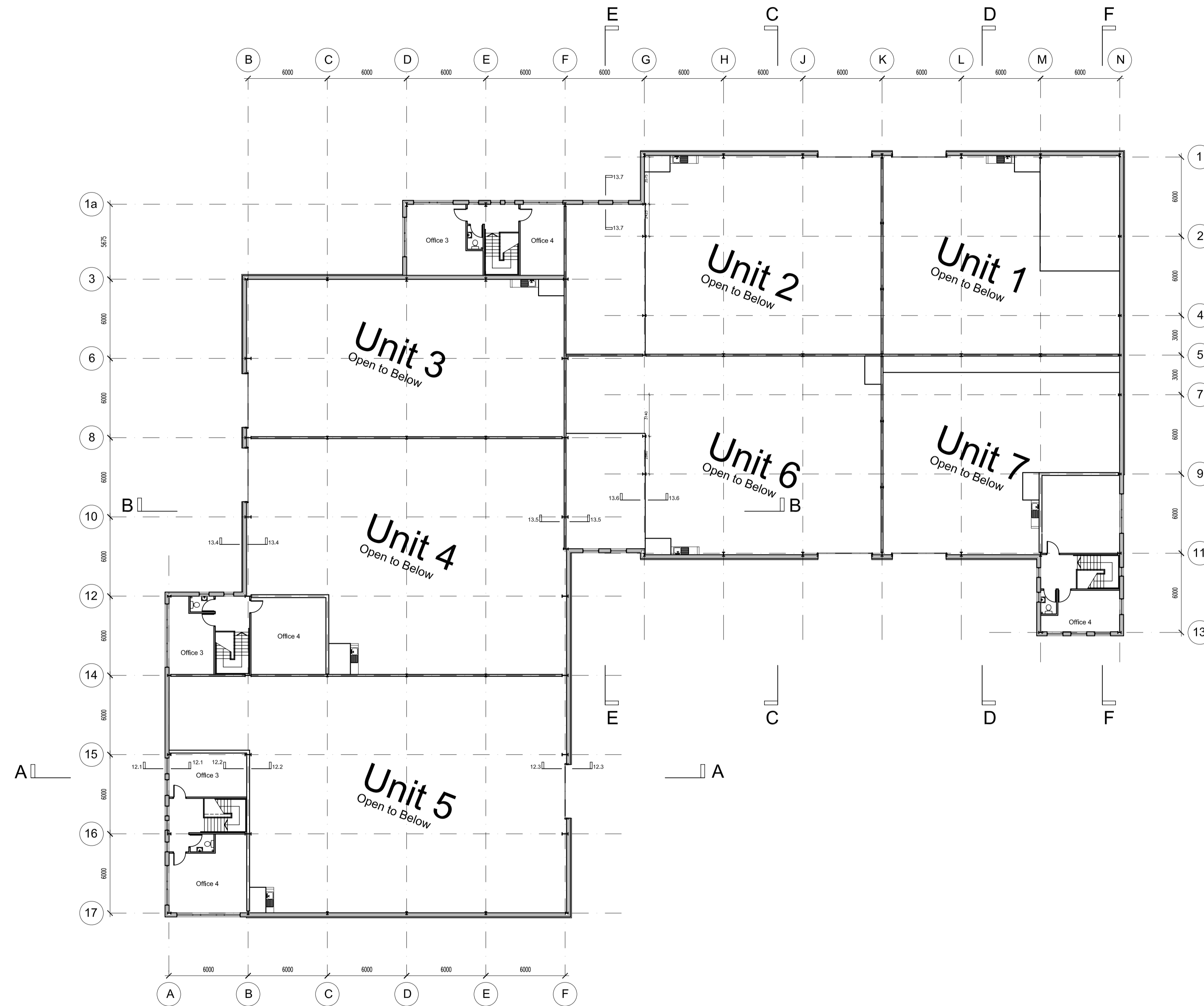
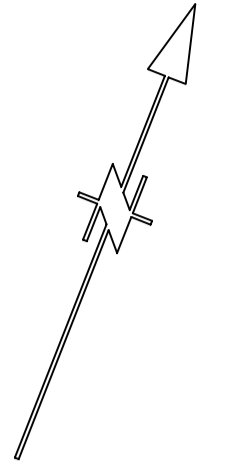

Proposed First Floor Plan

Rev G: 05/04/07 - Layout & drainage to Unit 5 amended.
 Rev F: 18/08/06 - Size & position of roller shutter doors amended.
 Steelwork to G.L. 11, F also amended.
 Rev E: 01/08/06 - Revised to suit Structural Engineers steelwork & Clients requirements.
 Rev D: 16/06/06 - Stairs amended.
 Rev C: 26/05/06 - Windows & section D-D positions amended.
 Rev B: 19/05/06 - Units 3, 4 & 5 moved, toilets added plus windows & griddlines amended.
 Rev A: 21/04/06 - Unit 7 offices & external wall amended. Griddlines & dims added.

Client
D. Noble Ltd.

Project
Plot 11
Grimethorpe

Drawing
Block A Proposed First Floor Plan



Unit 11 South West Centre
 Troutbeck Road, Sheffield S7 2QA
 E-mail: design@selfarchitects.co.uk
 tel. 0114 250 8900
 fax. 0114 255 8900

Drawn by	Date	Scale
art	Feb' 06	1:200 @ A1
Checked by	No.	Rev.
	3279-08	G