

NOTES:
DO NOT SCALE. IF IN DOUBT, ASK.

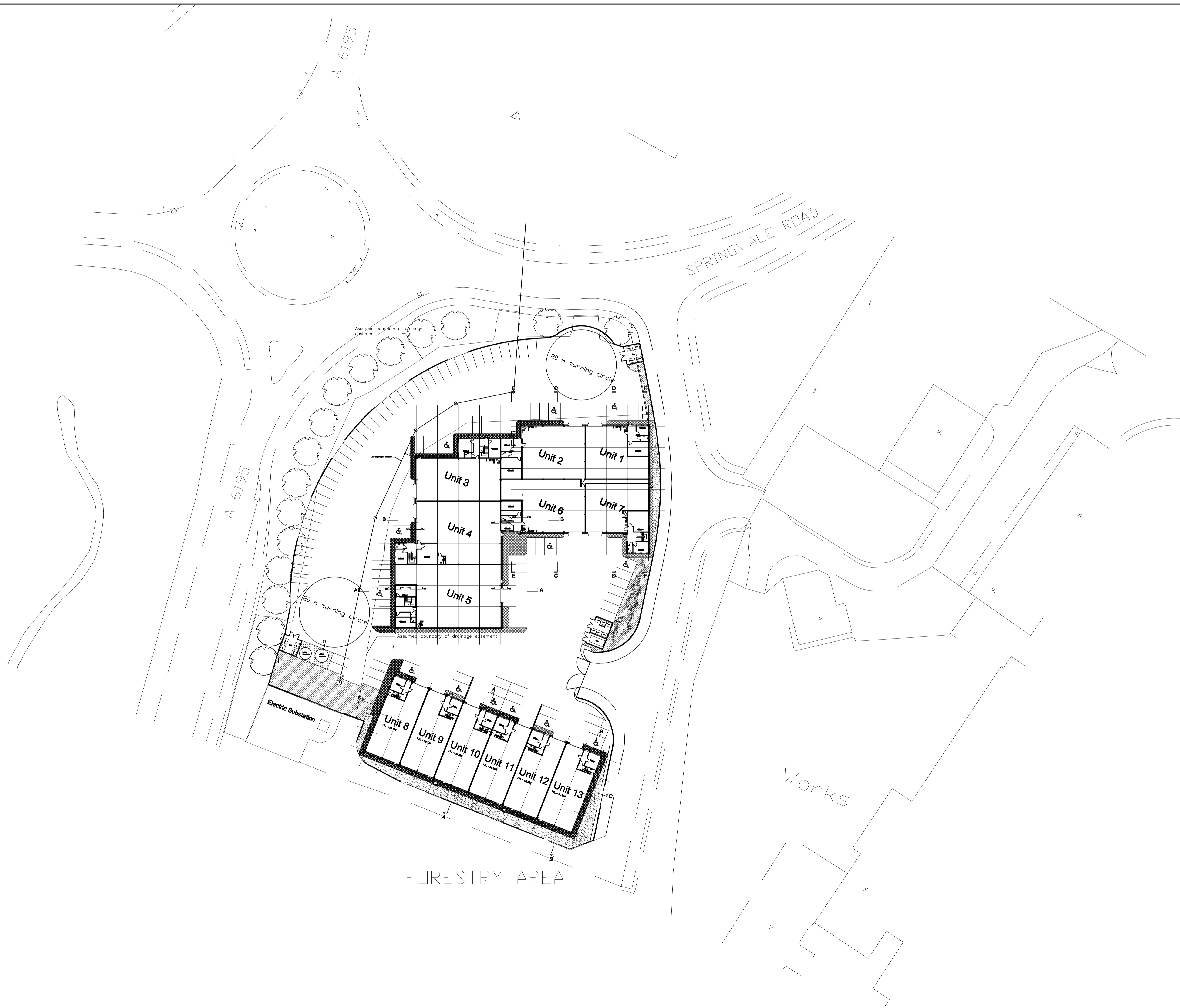
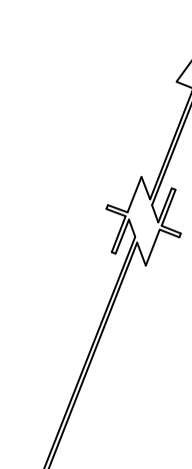

Rev K: 14/09/06 - Block B revised.
 Rev J: 01/12/06 - Position of the fire exit door to Units 8 & 11 amended.
 Rev H: 14/08/06 - Car parking layout near Unit 8 amended to suit drainage layout.
 Rev G: 16/08/06 - Size & position of roller shutter doors amended to block A. Steelwork to G.L. 11, F & refuge area amended plus bollards added.
 Rev F: 01/09/06 - Revised to suit Structural Engineers steelwork & Client's requirements.
 Rev E: 14/05/06 - Bin stores added & Parking layout & stairs amended.
 Rev D: 28/05/06 - Updated to 3279-04F.
 Rev C: 24/04/06 - Block B, floor plan amended.
 Rev B: 21/04/06 - Block A, Unit 7 office & external wall amended.
 Rev A: 19/04/06 - Block B, floor plan amended.

Client
D. Noble Ltd.

Project
Plot 11 Grimethorpe

Drawing
Overall Site Layout



Unit 11 South West Centre
 Troutbeck Road, Sheffield S7 2QA
 E-mail: design@selfarchitects.co.uk
 Tel: 0114 290 8800
 Fax: 0114 296 8800

Drawn by	Date	Scale
art	Feb' 06	1:500 @ A1
Checked by	No.	Rev.
	3279-07	K